

RoHS HF C环保

Mark	ECN NO.	DESCRIPTION	DESIGN	Date:
A	—	New	—	—

NOTES:

- MATERIALS
 - .HOUSING: HIGH TEMPERATURE THERMOPLASTIC .(Not For I.R. Reflow Process)
 - .CONTACT: COPPER ALLOY
 - .PLATING: GOLD ON CONTACT AREA AND BRIGHT TIN OR MATTE TIN (LEAD FREE) ON SOLDER TAIL AREA AND NICK ON UNDERPLATING AREA
- ELECTRICAL
 - .VOLTAGE RATING: 250 VAC R.M.S.
 - .CURRENT RATING: 3 AMP
 - .INSULATION RESISTANCE: 1000 MEGOHMS Min.
 - .DIELECTRIC WITHSTANDING VOLTAGE: 500 VAC (R.M.S.)
 - .CONTACT RESISTANCE: 30 milliohms Max. (INITIAL)
- MECHANICAL
 - .CONTACT RETENTION FORCE: 460g Min. (PER PIN)
 - .INSERTION FORCE: 230g Max. (PAIR)---(GAUGE 1.58mm)
 - .WITHDRAWAL FORCE: 15g Min. (PAIR)---(GAUGE 1.58mm)
- ENVIRONMENTAL
 - .TEMPERATURE RANGE: -55°C TO + 85°C
- ROHS COMPLIANT.
 - .THIS COMPONENT AND ITS HOMOGENEOUS SUBCOMPONENTS ARE ROHS COMPLIANT.

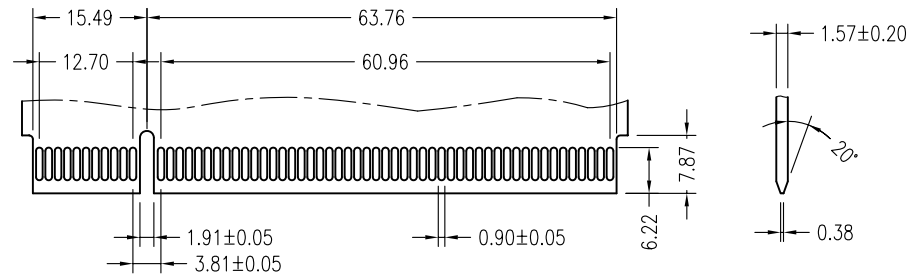
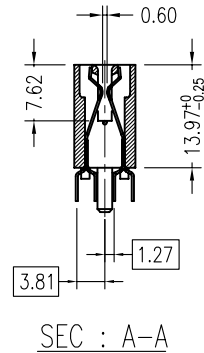
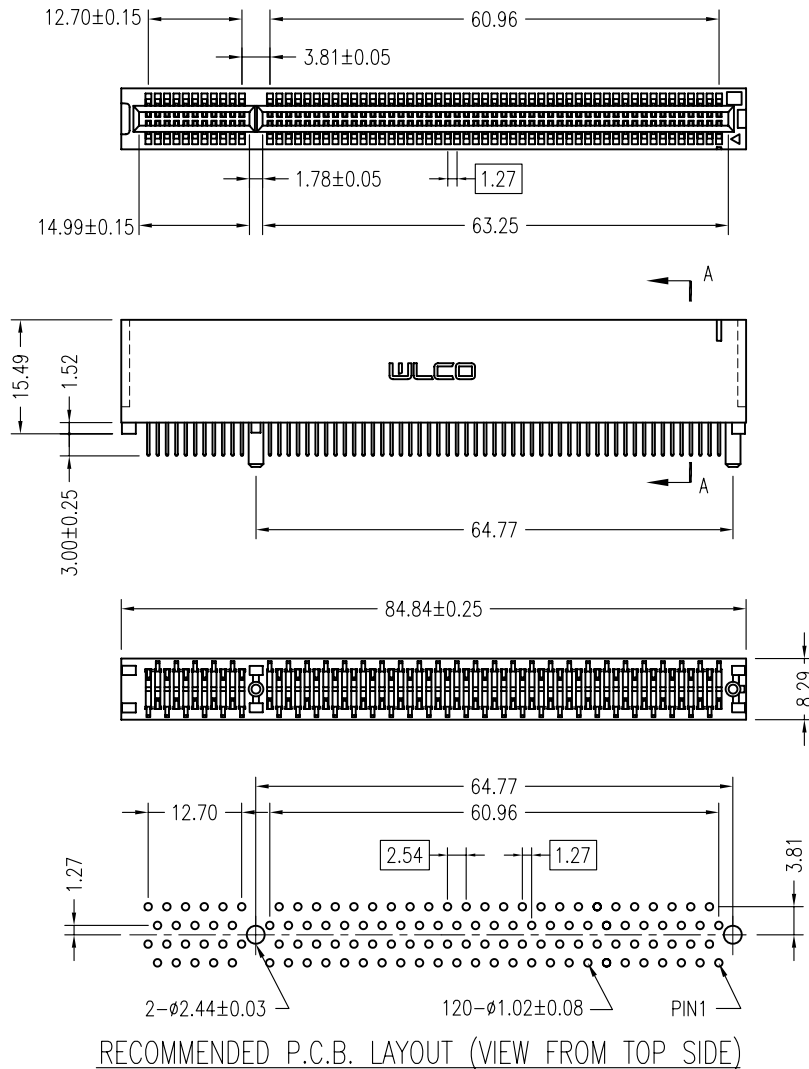

DAUGHTER CARD REQUIREMENTS

Tolerance	Model Name: PCI 120Pin PA66黑色 无扣 定位柱式 端子半金锡G.F	Drawing:	黄海祥
X.X ±0.30	Model No: WLPC-007A	Checked:	姚世宣
X.XX ±0.25	UNIT:	Approved:	李建
X.XXX ±0.15	mm	Date:	2018.06.28
Angle ±2.0°	SCALE: Full	REVISION: B	SHEET 1/1
	DWG NO.		
	FILE:		C

WILCO 深圳市兴万联电子有限公司
SHENZHEN XINGWANLIAN TECHNOLOGY CO., LTD